

TAVOLE N°	01/E	AGG.	AGG.
LAVORO N°	523	<b>Dott. Ing. Fulvio BAIETTO</b> Via Vastiti, 4 - 10121 TORINO Tel. 011/5629480 - Fax 011/510047 E-mail: studio_baietto@libero.it Albo Ing. To n. 2838L	
PROG. N°	4518		
SCALA	VARIE		

[illegible]

Technical cross-section diagram of a roof assembly. The diagram shows a concrete slab (300 mm thick) with a drainage channel (Solefko) containing two tubes (PEAD 100 PPH and Ø10 mm). The assembly is covered with a waterproofing membrane (Materiale impermeabile) and a gravel layer (Gravillato). Dimensions include 300 mm for the slab thickness, 100 mm for the channel height, and 100 mm for the gravel layer. A legend indicates 'Ø = diam. tubazione' and 'Ø = 100 mm'.

The image contains two technical cross-section drawings of roof drainage manholes.

**Left Drawing:** Shows a standard manhole. It has a vertical shaft with a diameter of 100 units. The shaft is surrounded by a brick or masonry structure. At the bottom, there is a horizontal pipe connection. Labels include:
 

- 100 (indicating the shaft diameter)
- Tubazione di mandata alla vasca di accumulo esistente (Existing collection tank outlet pipe)
- Tubazione in P.O.D. 100/100 (ø 100 mm in PVC) dalla nuova opera di copertura (P.O.D. 100/100 (ø 100 mm in PVC) from the new cover work)

**Right Drawing:** Shows a new manhole with a cover plate. It has a vertical shaft with a diameter of 100 units. The shaft is surrounded by a brick or masonry structure. At the bottom, there is a horizontal pipe connection. Labels include:
 

- 100 (indicating the shaft diameter)
- Tubazione di mandata alla vasca di accumulo esistente (Existing collection tank outlet pipe)
- 100 (indicating the horizontal pipe diameter)
- Nuova struttura (New structure)
- Tubazione in P.O.D. 100/100 (ø 100 mm, di mandata alla nuova opera di copertura) (P.O.D. 100/100 (ø 100 mm, for the new cover work))

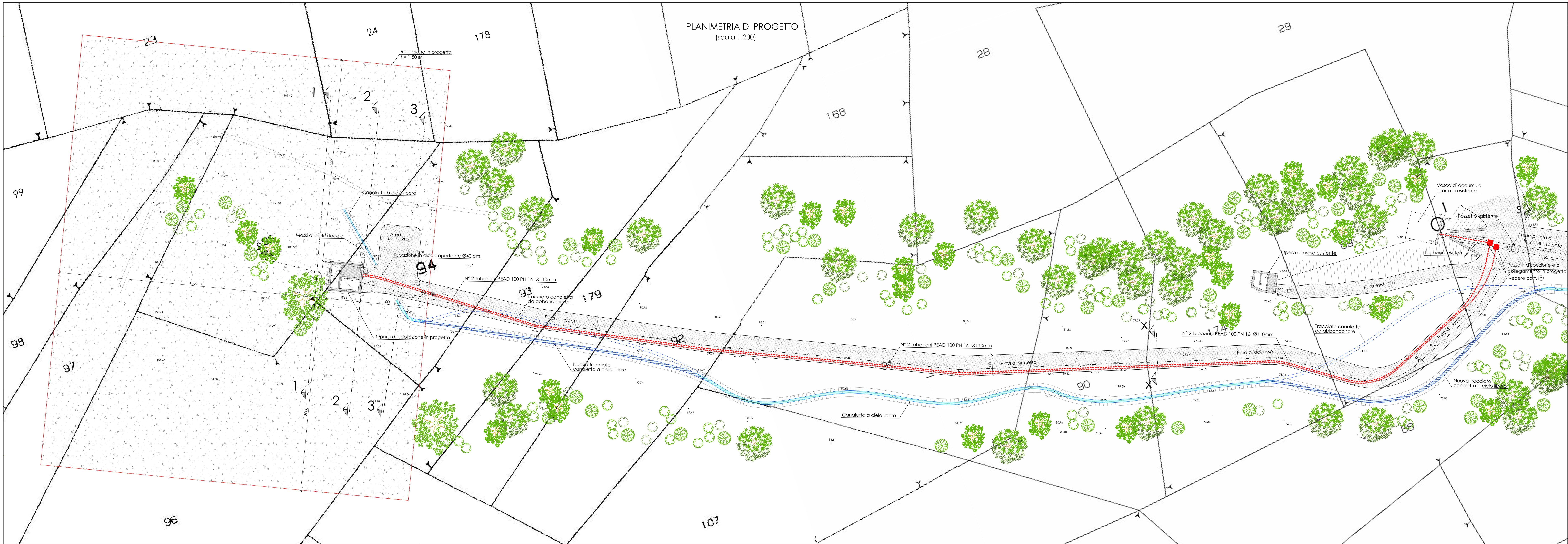

PROFILO LONGITUDINALE S-S  
(scala 1:200)

Nuova opera di captazione

Tubazione in cls autoportante Ø40 cm

n° 2 tubazioni PEAD 100 Pn16 Ø110 mm in progetto

n° 2 tubazioni PEAD 100 Pn16 Ø110 mm in progetto

Profilo pinto in progetto

Profilo attuale

11%

16%

19%

17%

10%

[illegible]

### OPERA DI CAPTAZIONE - SEZIONE A-A - (scala 1:50)

[illegible][illegible]